

# Dektite® Aluminium

The versatile solution for hundreds of applications.



The base is 99.9% pure grade aluminium - strong, malleable and easy to install.

Environmentally friendly, ideal where potable water is collected.

## INSTALLATION INSTRUCTIONS

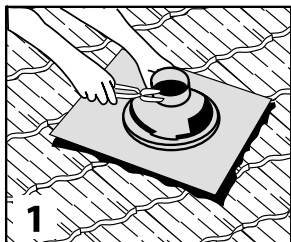

1 Trim Dektite™ cone to suit pipe size using sharp tin snips

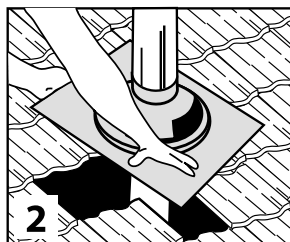

2 After lubricating the flue with water, slide Dektite™ down to the tile level.

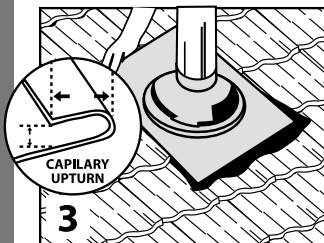

3 Place upper edge of base under tiles, forming an anti-capillary fold

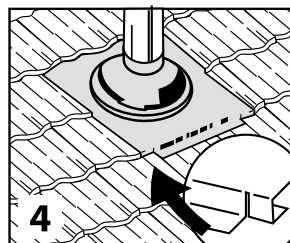

4 Cut tabs and then just press and tap the bottom corners to form a soaker run-off tray.

## Easy Selection Guide

Code	PIPE mm	BASE mm	PITCH	COLOUR
TFA 12-70	12 - 70	600 x 450	0 - 40°	} <b>BLACK (EPDM)*</b> <b>RED (EPDM)*</b>
TFA 50-170	50 - 170	600 x 500	0 - 45°	
TFA 110-220	110 - 200	900 x 600	0 - 45°	
TFA 160-300	160 - 300	900 x 764	0 - 45°	

E.P.D.M. withstands temperatures from -50°C to 115°C, & up to 150°C intermittently

HINT: When flashing a metal flue that has an exposed seam, using a neutral cure sealant, seal the seam from underside of cowl to the top of Dektite® cone.

# Dekstrip® Flashing



With the amazing patented stretch edge

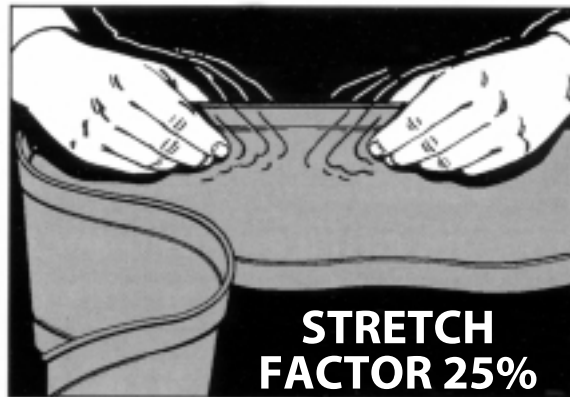

The edges of Dekstrip® contain an expanding aluminium strip (in concertina form) totally encased by the E.P.D.M. rubber flashing. The strip allows the flashing to be stretched and formed around most roof profiles - and maintain that shape. Fastening may be done through the aluminium strip using fasteners with a minimum 10mm diameter head.

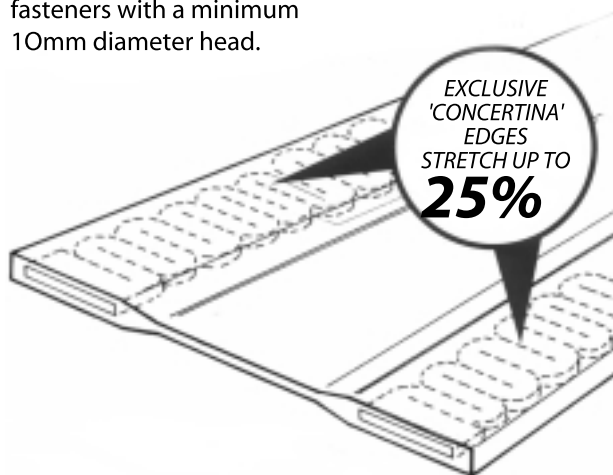

Both edges of Dekstrip® stretch up to 25% and retain shape over most roof cladding profiles.